

CORPO: INTERPON YAZD2525 SABLE'

FONDO SCARICATO

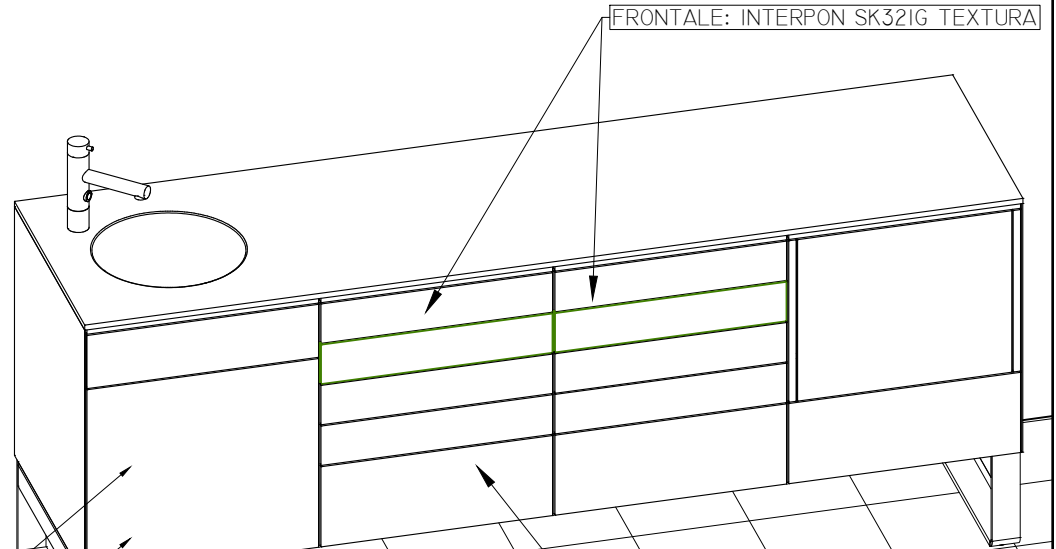
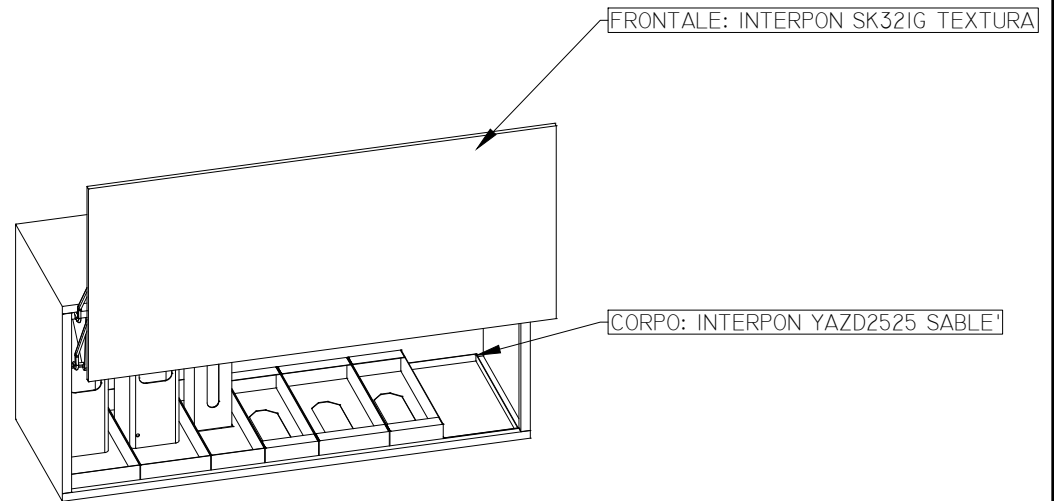

FRONTALI: INTERPON YAZD2525 SABLE'

SEZIONI PIANO - TOP SECTION

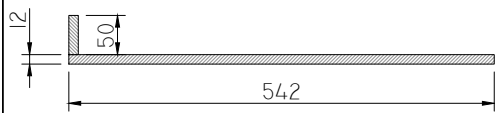

<http://www.saratogadental.it>
e-mail: info@saratogadental.it

ALL RIGHTS RESERVED

CUSTOMER: SARATOGA

REFERENCE: RIMINI 2019

DATE: 09-04-19

DIR: DTBS_PRG/5-PROGETTAZIONE/7-FIERE

SCALE: 1:20

FILE:

TEC SIGNATURE:

FIRMA CLIENTE PER ACCETTAZIONE
CLIENT SIGNATURE FOR ACCEPTANCE

LINE: SIGN

TOP: HI MACS

HANDLE:

SINK: HI MACS

COLOURS

BODY: Sablé

FRONT: Sablé

HANDLE:

TOP: S028 ALPINE WHITE

ALL BENCHES AND EQUIPMENTS ARE SUPPLIED AT

SOLUTION

B

TAV. No.

6

DES.: DB

110 V 60 H
 230 V 50 H

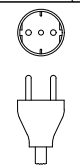

TIPE-F